

CODE 1003

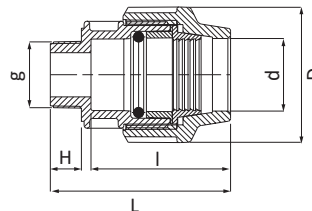

Male adaptor - Anschlussverschraubung mit Aussengewinde - Муфта с наружной резьбой



CODE	dxg [mm]	D [mm]	L [mm]	I [mm]	H [mm]	PN [bar]
1003016001001	16x3/8"	42	65	54	13	16
1003016002001	16x1/2"	42	69	54	16	16
1003016003001	16x3/4"	42	69	54	17	16
1003020002001	20x1/2"	46	81	62	16	16
1003020003001	20x3/4"	46	84	62	19	16
1003020004001	20x1"	46	85	62	19	16
1003025002001	25x1/2"	55	89	68	16	16
1003025003001	25x3/4"	55	90	68	17	16
1003025004001	25x1"	55	92	68	19	16
1003032002001	32x1/2"	63	98	75	16	16
1003032003001	32x3/4"	63	98	75	16	16
1003032004001	32x1"	63	100	75	19	16
1003032005001	32x1"1/4	63	104	75	23	16
1003032006001	32x1"1/2	63	104	75	23	16
1003040004001	40x1"	79	108	80	21	16
1003040005001	40x1"1/4	79	109	80	21	16
1003040006001	40x1"1/2	79	109	80	21	16
1003040007001	40x2"	79	112	80	25	16

>>>

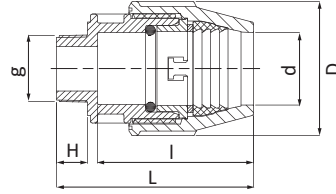

>>>

CODE	dxg [mm]	D [mm]	L [mm]	I [mm]	H [mm]	PN [bar]
1003051004001	50x1"	96	150	108	25	16
1003051005001	50x1"1/4	96	143	108	28	16
1003051006001	50x1"1/2	96	145	108	27	16
1003051007001	50x2"	96	150	108	30	16
1003064005001	63x1"1/4	115	159	118	28	16
1003064006001	63x1"1/2	115	159	118	28	16
1003064007001	63x2"	115	162	118	31	16
1003064008001	63x2"1/2	115	167	118	36	16
1003076007001	75x2"	129	173	136	27	16
1003076008001	75x2"1/2	129	178	136	34	16
1003076009001	75x3"	129	178	136	34	16
1003091007001	90x2"	155	204	166	34	16
1003091008001	90x2"1/2	155	204	166	34	16
1003091009001	90x3"	155	204	166	34	16
1003091010001	90x4"	155	206	166	36	16
1003111007001	110x2"	183	249	215	34	16
1003111009001	110x3"	183	262	215	37	16
1003111010001	110x4"	183	262	215	37	16